

# louver twelve™



Covered by the following U.S. Patents: 5,733,028; 5,914,487; 5,967,652; 6,043,873; 6,064,061; 6,088,091; 6,238,077; 6,266,136; 6,334,700.

## FEATURES

Suspended direct/indirect ideal for low ceiling applications.

Twelve™ delivers 70% indirect/30% direct illumination.

The CU Filter precisely controls lamp brightness above the fixture to allow for 12" suspension lengths.

Sleek rectilinear design adds clean style to any space.

Parallel blade louver with acrylic lens diffuser provides comfortable downlight shielding.

Excellent choice for lower ceiling applications and areas where ceiling uniformity is important.

## companion luminaire



wall mount

## DIMENSIONAL DATA

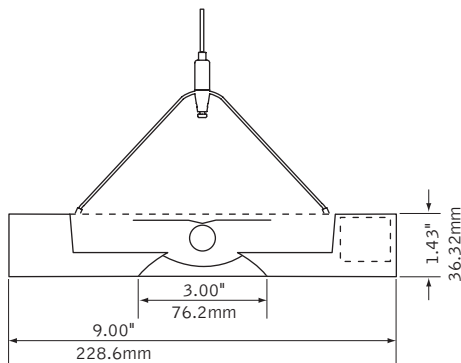

### lamping options



T5/T5H0 LAMPS

### fixture information

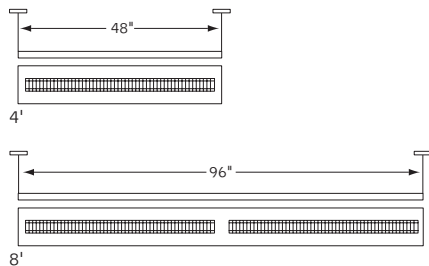

## PERFORMANCE

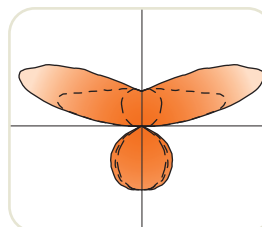

1-Lamp T5H0  
90% Efficiency  
1264 cd @ 115°  
69% Indirect  
31% Direct

See **Photometric** section for additional performance data.

fixture type:

project name:

## MOUNTING INFORMATION

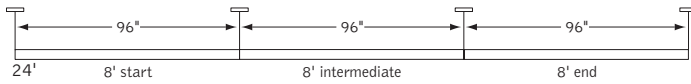
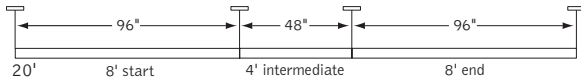
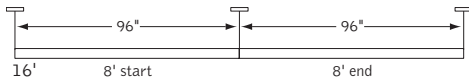
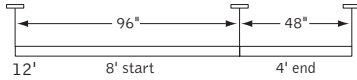

Consult factory for additional row length information.

## SPECIFICATIONS

### construction

One-piece 20 Ga. steel housing.

14 Ga. steel end caps mechanically attach flush to housing with concealed fasteners.

For row installation, internal brackets form hairline joint.

Standard lengths are available in 4' and 8'.

All luminaires are provided with Y-cable suspension mounted on 48" or 96" centers.

4' unit weight: 20 lbs.

8' unit weight: 38 lbs.

### optic

Reflector fabricated of low iridescent, semi specular premium grade aluminum.

Parallel Blade Louver: 24 Ga. steel, .5"H x 2.8"W x .56" frequency.

Louver blade finished to match housing and backed with an acrylic lens diffuser.

24 Ga. steel Ceiling Uniformity Filter (CU Filter) finished in high reflectance white powder coat.

### electrical

Luminaires are pre-wired with factory installed branch circuit wiring and over-molded quick connects.

Factory installed decorative metal braided power cord at feed location is included.

White SJT power cord supplied for 347V.

Electronic ballasts are thermally protected and have a Class "P" rating.

Optional DALI and other dimming ballasts available.

Consult factory for dimming specifications and availability.

UL and cUL listed.

### emergency

Emergency battery packs provide 90 minutes of illumination.

Initial lumen output for lamp types are as follows:

T5 Lamp: Up to 500 lumens

T5HO Lamps: Up to 825 lumens

Battery pack requires unswitched hot from same branch circuit as AC ballast.

### finish

Polyester powder coat applied over a 5-stage pre-treatment.

Standard luminaire housing finished in Matte Satin White or Titanium Silver.

Canopy finished in Matte Satin White.

## ORDERING

fixture series	FTWS
twelve	FTWS
<b>shielding</b>	<b>PB</b>
Parallel Blade Louver with CU Filter	PB
<b>lamping</b>	_____
1 Lamp T5	1T5
1 Lamp T5HO	1T5HO
2 Lamp T5	2T5
2 Lamp T5HO	2T5HO
<b>circuit</b>	_____
Single Circuit	1C
Dual Circuit (Multiple lamp fixtures only)	2C
<b>voltage</b>	_____
120 Volt	120
277 Volt	277
347 Volt	347
(Consult factory for availability)	
<b>ballast</b>	_____
Electronic Program Start <10% THD	S
Electronic Dimming Ballast (Consult factory for dimming availability)	D
<b>mounting</b>	_____
12" Cable Suspension (5" canopy at feed locations and 2" canopy non-feed locations) (specify "C" in place of "J" for 5" dia. canopies both at power feed and non-feed locations) (suspension may be adjusted up to 24". Consult factory for lengths longer than 24")	J12
Stem Mount (specify stem length in inches Stem painted white unless otherwise specified)	S__
<b>factory options</b>	_____
Emergency Circuit	EC
Emergency Battery Pack	EM
HLR/GLR Fuse	FU
Include 3000K Lamp	L830
Include 3500K Lamp	L835
Include 4100K Lamp (factory installed lamps recommended)	L841
<b>finish</b>	_____
Matte Satin White	WH
Titanium Silver (louver painted to match housing)	TS
<b>fixture run length</b>	_____
4'	4'
8'	8'
12' (8'+4')	12'
16' (8'+8')	16'
20' (8'+4'+8')	20'
24' (8'+8'+8')	24'
(individual units may not be field modified for continuous row mount)	

louver  
twelve™



Filename: FTWSPB1T5H.IES  
 Catalog #: FTWS-PB-1T5H0-1C-120-S-C12-WH-4'  
 Efficiency: 90%  
 Test #: 12096.0

CANDLEPOWER DISTRIBUTION

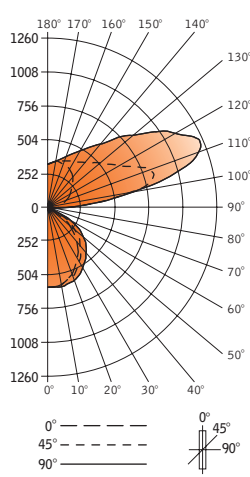

Vertical Angle	0°	Horizontal Angle				Zonal Lumens
		22.5°	45°	67.5°	90°	
0°	590	590	590	590	590	
5°	587	589	590	593	593	56
15°	551	553	562	575	582	160
25°	486	492	510	537	553	238
35°	394	404	429	464	486	273
45°	290	301	333	376	407	263
55°	178	193	226	269	301	208
65°	86	99	126	157	177	127
75°	29	41	52	60	59	52
85°	0	7	11	11	7	9
90°	0	0	1	1	1	
95°	17	171	105	74	69	107
105°	75	364	788	952	937	690
115°	136	315	772	1151	1264	729
125°	202	312	609	928	1051	555
135°	255	330	516	722	806	406
145°	321	355	449	550	302	285
155°	357	373	415	462	490	194
165°	373	377	385	399	410	110
175°	365	365	365	364	364	35
180°	352	352	352	352	352	

Spacing 1.1  
 Criterion: 1.3

LUMEN SUMMARY

Zone	Lumens	% Lamp	% Fixt
0°-30°	454	9.1	10.1
0°-90°	1387	27.7	30.8
90°-130°	2082	41.6	46.3
90°-180°	3112	62.2	69.2
<b>Total Luminaire</b>	<b>0°-180° 4498</b>	<b>90.0</b>	<b>100.0</b>

LUMINANCE DATA (CD/M<sup>2</sup>)

Vertical Angle	0°	45°	90°
45°	2147	2466	3014
55°	1625	2063	2748
65°	1066	1531	2193
75°	587	1052	1194
85°	0	661	421

CO-EFFICIENTS OF UTILIZATION

Floor	80				70				20						
Ceiling	50				30				10						
Wall	70	50	30	10	70	50	10	50	10	50	10	50	10	00	
RCR	0	92	92	92	92	83	83	83	65	65	49	49	35	35	28
1	85	81	78	75	76	73	68	58	54	44	42	31	30	24	
2	77	71	66	62	69	64	56	51	46	39	36	28	26	21	
3	71	63	57	52	64	57	47	46	39	35	31	25	23	19	
4	65	56	49	44	58	51	40	41	33	31	27	23	20	16	
5	59	50	43	38	53	45	35	36	29	28	23	21	17	14	
6	55	45	38	33	49	40	30	33	25	25	20	19	15	12	
7	51	40	33	29	45	36	26	30	22	23	18	17	13	11	
8	47	36	30	25	42	33	23	27	19	21	16	15	12	09	
9	43	33	27	22	39	30	20	24	17	19	14	14	10	08	
10	40	30	24	20	36	27	18	22	15	17	12	13	09	07	

Numbers indicate percentage values of reflectivity.

Go to [www.focalpointlights.com](http://www.focalpointlights.com) for additional photometric data.