

M60 Linear Fluorescent Recessed

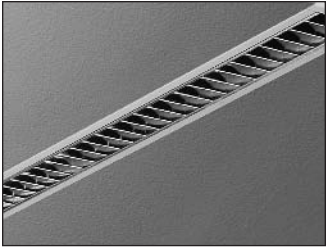

Project: _____ **Type:** _____ **Qty:** _____

Fixture Series **Lamp Type** **Shielding** **Mounting** **Linear Footage** **Finish** **Voltage**

Options (refer to separate data sheets for ordering codes and details)

Fixture Series	Lamp Type	Shielding	Mounting	Linear Footage	Finish	Voltage	Options
M6R1 M60 Recessed Continuous Flange (Flanged Extrusion/ Flanged Endcaps)	1T5 F28T5	MA Matte Parabolic	SH Suspension Clips	004 4 foot	WH White	120	TB Lengths to Fit 2' Grid T-Bar Ceiling System (M6R1 only) (qty.)EM Stand-by Battery Pack ¹ (prefix quantity, i.e. - 5EM) FS Single Fusing DM Dimming ¹ (specify system) DMA Digital Addressable Dimming ¹ SI Satine Acrylic Inlay ² FW Flex Whip (standard) FW1 Flex Whip (dimming) Track Eutrac Standard ³ DL Suitable for Damp Locations CCEA Chicago Plenum Downlights (See MR11 spec sheet, pp.98)
	1T5HO F54T5HO	MP Silky Specular Parabolic Louver	RC Rotating Crossbars PM Perimeter Mount	008 8 foot 012 12 foot	BK Black SV Silver	277 347	
M6R2 M60 Recessed Flush End (Flanged Extrusion/ Flangeless Endcaps)		SD Satine Lens OD Extra Diffuse Lens	TS 1" Studs (factory installed)	For actual lengths see layout dimensions. For other lengths, configurations indicate nominal length rounded to the next highest foot. Factory will supply layout drawings. Individual fixtures cannot be field joined.	SP Specify RAL#		

¹Must be low profile ballasts (1 3/8" wide x 1 3/8" high); consult factory for details.

²Available for MP Louver only.

³Consult factory for details.

Mounting Diagrams

Suspension Clips (SH)

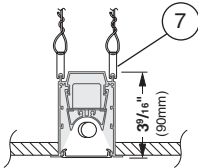

Pre-installed Rod (TS)

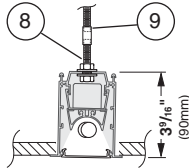

Rotating Crossbars (RC)

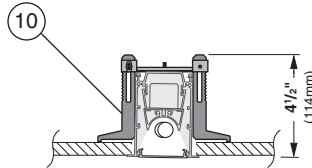

Perimeter Mount (PM)

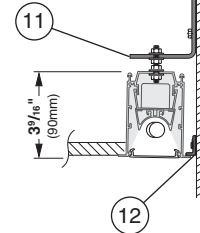

Scale = 1 : 8

Track

Track insert including track available for all configurations, consult factory for details.

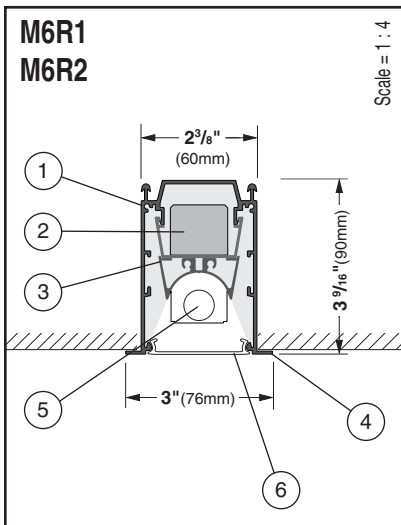
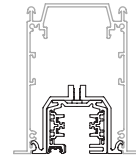

Scale = 1 : 4

1. Housing - Continuous, 6063-T5 extruded aluminum profile up to 16 feet long.

2. Ballast - Electronic, high power factor, class "P", type "A" sound rating. Specify 120v, 277v, or 347v. Ballast is factory pre-wired with leads to one end of fixture. Consult factory for ballast options.

3. Gear Tray - Die formed tray with specular aluminum reflector. Gear tray installs as complete electrical unit and is held in place with 1/4 turn latches. It is fully accessible from below ceiling.

4. Flange - 5/16" (8mm) wide flange is part of the main extruded body. Specify continuous flange (M6R1) or flush end (M6R2).

5. Lamps - As noted (by others). Other lamp lengths or wattages available, consult factory.

6. Shielding - Louvers offer excellent glare control in longitudinal, lateral, and all diagonal planes. High quality aluminum louvers and acrylic shielding allow true freedom of layout for today's modern spaces.

7. Spring steel suspension clips - Supplied two places, located nominally every 4 ft. Support wires Supplied and installed by others.

8. Pre-installed 1" 1/4-20 Stud - Attached to fixture every nominal 4 feet.

9. Coupling and Threaded Rod to Structure - Supplied and installed by others.

10 Rotating Crossbar - For inaccessible ceilings, adjustable for ceiling thicknesses from 1/4" to 2". Support required nominally every 4'.

11. Steel Wall Bracket and 1/4-20 Rod - Supplied nominally every 4 ft. (Fasteners to wall and wall anchors by others.)

12. Aluminum Wall Bracket - Secured to wall (fasteners and wall anchors by others) and runs entire length of fixture. Also supplied for width of M6R1 continuous flange fixtures. Allows for 1/8" gap between flange and wall to create shadow line.

Interior Luminaire Finish - Standard interior colors are White (WH), Black (BK) and Silver (SV). RAL Classic colors (SP) are available, please specify RAL#.

SELUX Corp. © 2006
 TEL: (845) 691-7723
 FAX: (845) 691-6749
 www.selux.com/usa
 M6R-01 (v5.0)



Union Made Affiliated
 with IBEW Local 363

In a continuing effort to offer the best product possible, we reserve the right to change, without notice, specifications or materials that in our opinion will not alter the function of the product. Specification sheets found at www.selux.com/usa are the most recent versions and supercede all other printed or electronic versions.

M6R1 and M6R2 Standard Layout Dimensions

M6R1 Recessed - nominal 4 foot individual



M6R1 Recessed - T-Bar Length - nominal 4 foot individual

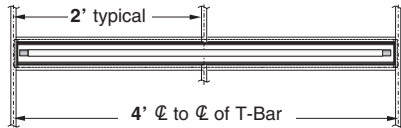

M6R1 Recessed - nominal 8 foot individual



M6R1 Recessed - T-Bar Length - nominal 8 foot individual

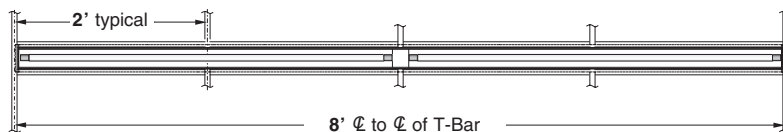

M6R1 Recessed - nominal 12 foot individual



M6R1 Recessed - T-Bar Length - nominal 12 foot individual

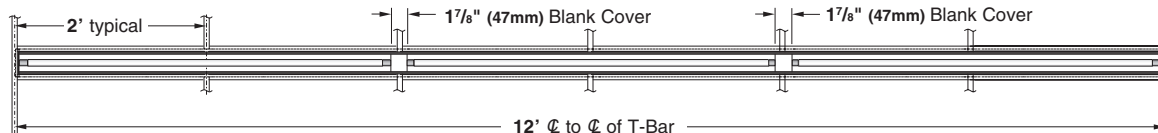

Continuous Flange (M6R1)



Flush End (M6R2)



Typical Side View

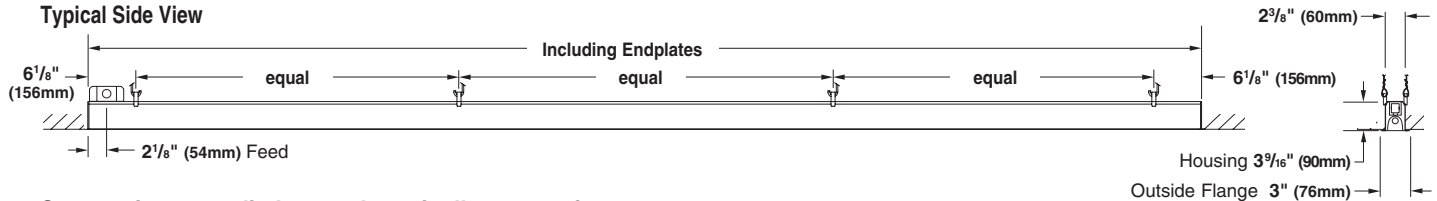

Suspensions supplied spaced nominally every 4 feet.

Fixture supplied with 7/8 knockout located 2 1/8" from end in top of fixture.

	T5 (1 or 2 lamp)			
	M6R1/M6R2 Including Endplates	M6R1 Outside Flange	M6R1/M6R2 - TB Including Endplates	M6R1 - TB Outside Flange
4 foot individual	47.28" (1201mm)	46.63" (1184mm)	47.03" (1195mm)	47.91" (1216mm)
8 foot individual	93.72" (2380mm)	93.03" (2362mm)	95.21" (2418mm)	95.88" (2435mm)
12 foot individual	140.13" (3559mm)	139.43" (3541mm)	143.25" (3638mm)	143.22" (3638mm)

For other lengths, lampping, continuous runs or configurations please specify overall length (in feet), accessories desired and sketch/drawing of configuration. SELUX will detail project drawings upon order and supply submittal drawings for approval. Individual fixtures cannot be field joined. If you have any questions please contact SELUX customer service or applications engineering for assistance (1-800-SELUX-CS).