

**CORONA Low Voltage Lightstrip**

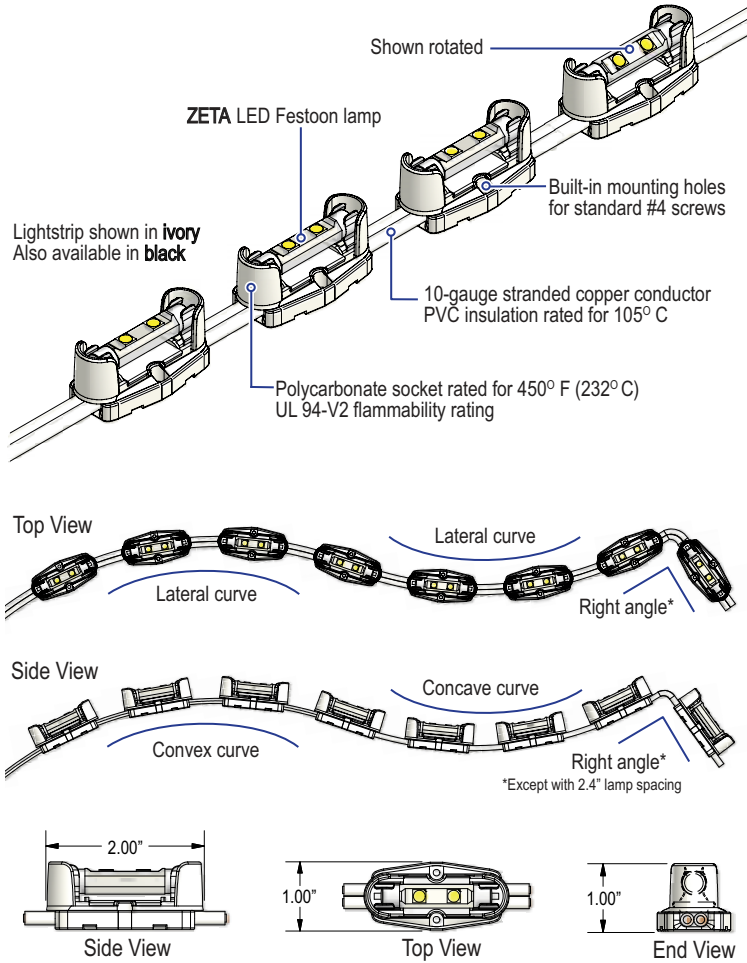

**CORONA Lightstrip Features**

- Flexible cable allows lightstrip to bend in all directions, ideal for curvilinear architectural spaces
- Low and narrow profile provides inconspicuous and versatile solution for smaller spaces
- Available in ivory or black color
- Offered in 2.4" or 3.0" lamp spacing
- Can be cut to length in field, for ease of ordering and installation
- UL Listed as Low Voltage Lighting System

**Lamp Spacing & Mounting Position**

For shadow-free light in coves and other indirect applications, keep minimum distance from illuminated surface.

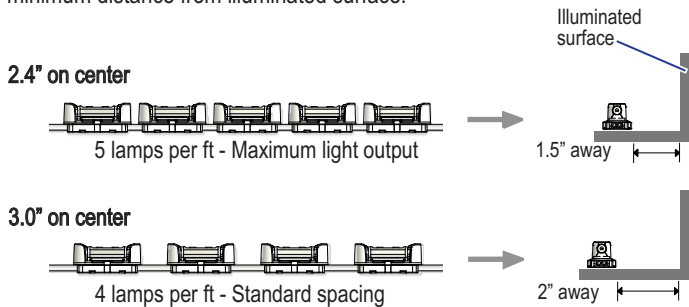

**ZETA LED Festoon Lamp**

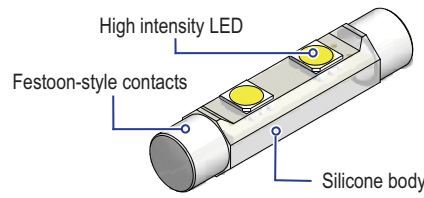

- 35 lumens per lamp
- 120° beam angle
- 0.96 watts per lamp
- 24V AC or DC
- 50,000 hrs rated life
- 3100K warm white or 5000K cool white
- Retrofits into standard festoon strips

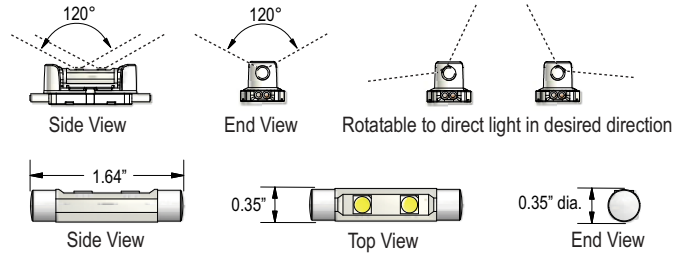

**ZETA Lamp Features**

**Optical Characteristics**

- Provides 35 lumens per lamp, comparable to standard 24V 5W Xenon festoon lamp
- Uses LED chips developed by Toyoda Gosei
- 120° wide beam angle minimizes hot spots and socket shadows, creating even illumination
- Tight color-binning of LEDs ensures uniformity of color
- 3100K warm white version emulates halogen light
- 5000K cool white version emulates fluorescent light
- Emits no UV and no IR

**Electrical Specifications**

- Consumes only 0.96W per lamp
- Runs on 24V AC or DC
- Operates with standard magnetic transformers as well as LED drivers
- Dimmable with standard magnetic low voltage dimming systems
- Built-in current regulator protects LEDs against accidental spikes

**Heat Management and Rated Life**

- 0.04 Amp operating current of LED generates lower heat, which is further dissipated by silicone body
- Low operating current and effective heat management protect LED life
- Rated life is 50,000 hours, with minimum 70% lumen maintenance, when used in normal environmental conditions
- Long life results in low maintenance and replacement costs
- Produces virtually no radiant heat; optimal for applications where heat must be avoided

**How to Specify CORONA ZETA Series**

COR-		-		-	
	CORONA Lightstrip Color		ZETA LED Festoon Lamp		Lamp Spacing
	I	Ivory	ZW	3100K Warm white	2.4 2.4" on center
	B	Black	ZC	5000K Cool white	3.0 3.0" on center
Eg.	COR-		B	-	ZW
				-	3.0

**Accessories**

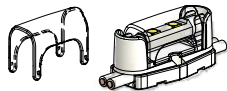

**Lens Cover**  
COR-LC

To prevent tampering with lamps where lightstrip is in accessible area.  
Clear polycarbonate.

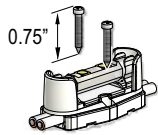

**Mounting Screw**  
COR-MS

Standard #4 screw. Use 2 per socket to mount lightstrip to surface.

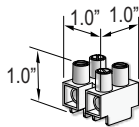

**Terminal Block**  
COR-TB

To connect feed wire from power supply to lightstrip, where conduit not required.

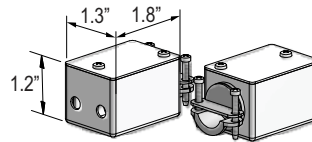

**Junction Box (Terminal Block included)**  
COR-JBI (Ivory)  
COR-JBB (Black)

To connect feed wire from power supply to lightstrip, where conduit is required. Accepts 1/2 or 3/8 trade size conduit.

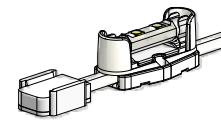

**End Cap**  
COR-ECI (Ivory)  
COR-ECB (Black)

To terminate lightstrip at end of run. Snaps onto lightstrip.

**Channels & Lenses**

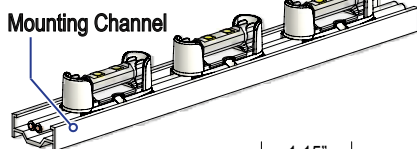

**Mounting Channel**  
COR-MCI (Ivory)  
COR-MCB (Black)

To align and mount lightstrip quickly in straight runs. Screw-mount to surface and snap in lightstrip. Eliminates need for screwing down each socket. Made of PVC. Order in 5ft. sections, cut to length.

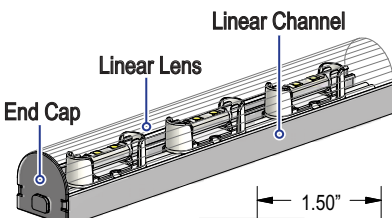
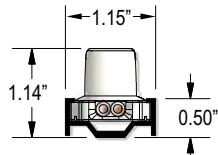

**Linear Lens**  
COR-CLL (Clear)  
COR-OLL (Opaque)

Acrylic lens for concealing or protecting lightsource. Clear lens contains serrations which diffuse light. Opaque lens further minimizes point source of light. Order in 5ft sections, cut to length.

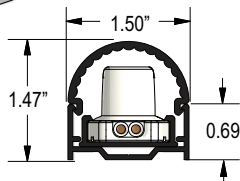

**Linear Channel**  
COR-SC (Satin)  
COR-WC (White)  
COR-BC (Black)  
COR-AC (Polished Aluminum)  
COR-GC (Polished Gold)

Aluminum channel for use with Linear Lens. Screw mount to surface, snap in lightstrip, and snap in Linear Lens.

Standard finishes: satin, white or black  
Optional: polished aluminum or polished gold.

Order in 5ft sections, cut to length.

Add suffix "EC" to above codes to order matching end caps.

**Power Supplies**

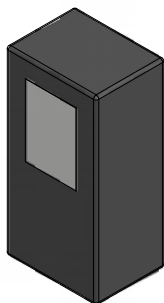

Part No.	Volts	Watts	Outputs	Dimensions	Weight
APS-120-100	120V to 24VAC	100W	1 x 100W	7.0"H x 6.5"W x 5.0"D	11 lbs
APS-120-300	120V to 24VAC	300W	3 x 100W	7.0"H x 6.5"W x 5.0"D	12 lbs
APS-277-100	277V to 24VAC	100W	1 x 100W	7.0"H x 6.5"W x 5.0"D	11 lbs
APS-277-300	277V to 24VAC	300W	3 x 100W	7.0"H x 6.5"W x 5.0"D	12 lbs

Mount to secure surface in accessible area with adequate ventilation, no further than 20ft from start of LED strip.

**Enclosure:** NEMA 3R, with conduit knockouts

**Overload protection:** Automatic shut-down / reset

**Operating temperature:** -30° C to 60° C

**Certification:** UL / ETL Listed Class 2

**Dimming:** Wire magnetic low-voltage dimmer to input side

**How to Feed CORONA ZETA**

**2.4" spacing** (Maximum 20ft per run)

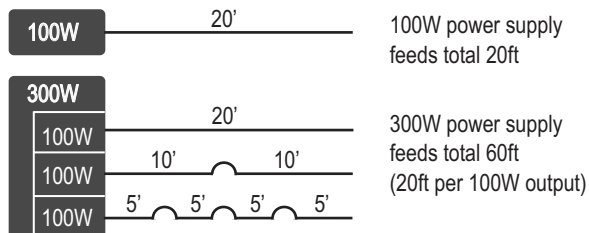

Multiple sections of lightstrip may be daisy-chained together, so long as total length of lightstrip sections does not exceed 20ft.

**3.0" spacing** (Maximum 25ft per run)

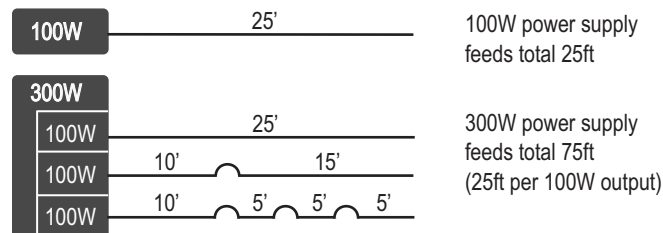

Multiple sections of lightstrip may be daisy-chained together, so long as total length of lightstrip sections does not exceed 25ft.