



INFINIUM™ "Pulse Tech" SERIES

SELF COOLING LED
1/2/3/4 HEAD



FEATURES & SPECIFICATIONS:

- Spectrum Infinium LED multiples offer the latest in high powered LED technology, in a versatile multi head platform.
- Available in 1/2/3/4 head configurations.
- Fixture heads rotate and tilt at ceiling level to 30° for optimum aiming.
- Infinium "Pulse Tech" features integral air-cooling technology.
- Single high powered LED produced point source quality and luminaire focus.
- 50,000 hours rated lamp life means low maintenance.
- High flux density 14 watt LED.
- All LED modules are replaceable and up-gradable
- Equivalent to 50 watt MR16, 20 watt metal halide, and 75 watt incandescent lamps.
- Manufactured and tested to UL Standard No. 1598.

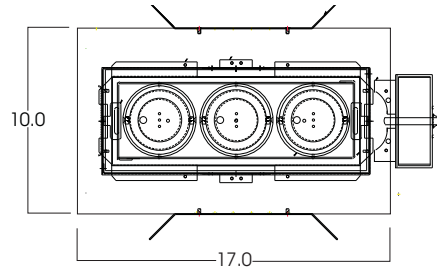
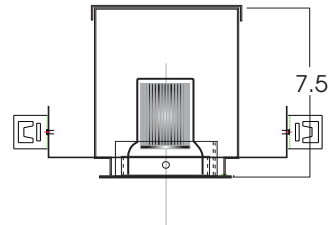
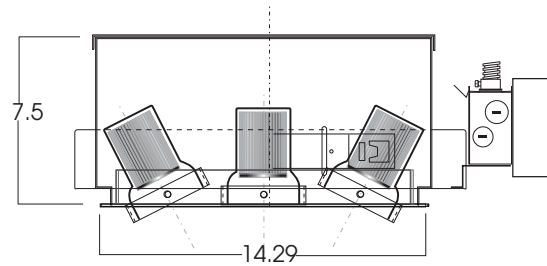

SERIES	LED	KELVIN	CRI	LUMENS	BEAM	VOLTS	OPTIONS	INTERIOR FINISH	TRIM / FINISH
RC44LED	1X14W	2K (2800K)	80	340	12D 21D 38D	E1-120	BH6 -Expandable Bar Hangers, 6" - 12"	MW -Matte White	FD44 MW - Matte White
RC48LED	2X14W						BH12 -Expandable Bar Hangers, 12" - 24"	MB -Matte Black	FD48 TW -Textured White TB -Textured Black
RC412LED	3X14W	3K (3200K)	90	350	12D 21D 38D	E1-120	24 -C-Channel bars 1-470	CC -Custom Color	FD412 MT -Mini Tek
RC416LED	4X14W						A -Chicago Ceiling Plenum CCEA 1-480		FD416
		4K (4100K)	70	420	12D 21D 38D	E1-120	CR -Corrosion Resistant 1-460		
							PR -Plaster Ring 1-430		
							TBC -T-bar clips 1-475		
							EMLED -Emergency Back-up Battery		
							DIMLED -LED Dimming Module		
SGRC412LED	3X14	3K			21D	E1		MW	FD412MW

Dimensions shown are nominal. Spectrum Lighting is continually improving products and reserves the right to make changes that will not alter performance or appearance with or without written notice.



PROJECT:	TYPE:
CAT.	

