

Gizmo family floodlights

Gizmo, gizmo mini, gizmo micro and gizmo nano
LED, metal halide and halogen
CSA listed wet label
IP65 suitable for up or down aiming with “Light Lock”

designplan 

designplan  MEYER LIGHTING



At the Zollverein colliery in Essen, the last coal was brought to the surface in 1986 and the adjoining coking plant was closed in 1993. This industrial monument is on the UNESCO World Heritage list. Thanks to a concept of "Preservation by new Utilization" it has now become the center of creative business in the Ruhr area.

The timeless and functional lighting design increases the attractiveness of the site at night and makes it easier for visitors to find their way around. The illumination pit head frame at shaft XII is visible for miles around and is the emblem of the park. Gizmo floodlights in various wattages are used in the lighting scheme. A central element in the design concept of the extensive park area are steel girders used as poles into which gizmo floodlights of various wattages have been recessed.

The lighting design office Licht Kunst Licht won a GE Edison Award 2008 for this efficient and at the same time atmospheric lighting concept



Lighting design:
Licht Kunst Licht, Bonn/Berlin



Bonn cathedral boasts the only 12th century cloister north of the Alps. The remodeling of the inner courtyard entailed a new lighting concept which represents a modern adaption of a medieval lighting scenario. The repetition of zones of light and shadow accentuate the vaulted architecture. In the courtyard Gizmo floodlights have been installed in custom made in-ground recess boxes and are used to create festive illumination for special events. By illuminating all four courtyard façades, the size and materials of the space take on a special aura.



Lighting design:
Mailänder Licht Design, Cologne



The Schweizer Bundeshaus was built in 1902 as the Swiss Parliament building according to the plans of the architect Hans Wilhelm Auer in the so-called historian style. It was the first public building in Switzerland to be equipped with electric lighting. In 2009 comprehensive alterations were completed under the auspices of the architects Aebi & Vincent.

Lighting consultants Vogt & Partner developed a concept worthy of the significance and history of this building which included the careful accentuation of façade details. The golden decoration of the cupola and the copper roof covering are illuminated using light sources with a warm color temperature. Luminaires of several product lines were used in this complex lighting design. The main and south cupola is illuminated using Moonshine floodlights with rotationally symmetrical reflectors. For the façade details gizmo floodlights of various wattages have been used. The light for the lantern and the gable is provided by Nightline Linear luminaires for T5 lamps. The intrados and passages are illuminated using Nightvision luminaires.



Lighting design:
Vogt & Partner, Winterthur

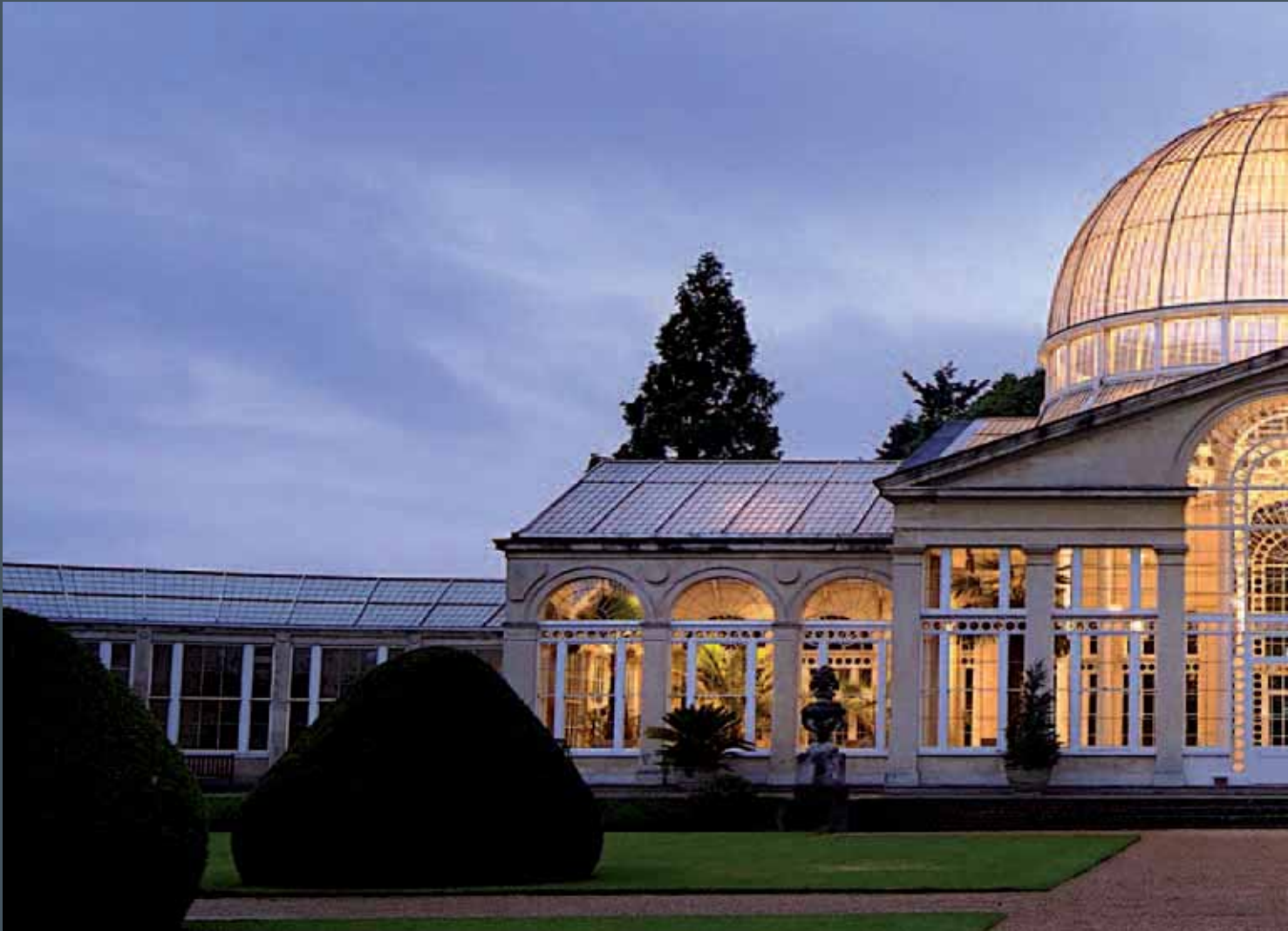

The architect Charles Fowler was commissioned to build the Great Conservatory at Syon Park on the outskirts of London in 1826. It was designed to house the Duke of Northumberland's collection of exotic plants. The objective of the new lighting concept is to provide general illumination by indirect lighting and at the same time accentuate certain plants. The light passing through the glass façade emphasizes the airiness of this impressive structure. This lighting concept was accomplished using Gizmo floodlights in various distributions and wattages



Lighting design:
Commercial Lighting Systems Ltd.,
Southampton



Place Stanislas was built in 1755 and with its baroque façades is today a UNESCO World Heritage Site. The comprehensive restoration on the occasion of its 250th anniversary included a new lighting concept. Highly atmospheric illumination of the façade was achieved using low wattage floodlights which offered the additional advantage of low energy consumption. Gizmo Mini floodlights with asymmetric reflectors were chosen. On the balconies at first floor level they were equipped with 39W metal halide and along the balustrade at the top of the building with 20W metal halide lamps.



Lighting design:
Pierre Yves Caillault/Communauté
Urbaine de Grand Nancy



The Gizmo family of floodlights is available for metal halide, LEDs and halogen. Thanks to their compact dimensions, the wide range of reflectors available and their timeless design, these luminaires have become indispensable tools for architectural lighting. There are 4 sizes of housing:

- . Gizmo nano for 5xmonochrome 3W LED
- . Gizmo micro for 20W metal halide
- . Gizmo mini for 39W metal halide
- . Gizmo for 39W and 70W metal halide and 300W halogen

A comprehensive range of accessories makes it possible to adapt these luminaires for specific lighting situations



Gizmo nano floodlights are available with neutral white or warm white LEDs.

New features include “Light-Lock”, a new patent pending mechanical device which indexes to the fixture and the yoke and allows for a positive lock return to aiming angles after maintenance. Not available on wall arm with joint.



Also available on Gizmo, gizmo mini and gizmo micro are internal louvers which sit behind the glass lens and prevent dirt and grime buildup common with external louvers.



Gizmo Nano with wall arm and joint

- . die cast aluminum body
- . 5x3W Cree leds
- . CSA listed wet label
- . IP65 suitable for up or down aiming
- . integral 120v driver
- . integral thermal monitoring device
- . tempered glass lens
- . polyester powder coat finish
- . complies with LM79 and LM80

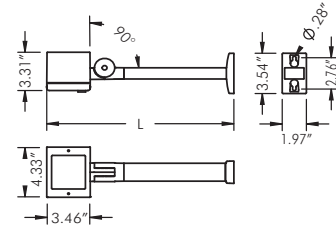

Note: Change the "B" to "Y" to convert from yoke mount to arm mount
 Note: Change the "0" to a "1" for short arm or "2" for a long arm

Gizmo Nano

Part number	Description	Length
LWN ...B.. 0 ...	LWN ...Y .. 1 ... Gizmo nano with short arm	15.75"
LWN ...B.. 0 ...	LWN ...Y .. 2 ... Gizmo nano with long arm	25.6"

Accessories for Superlight Compact Micro

Part number	Colour	Description
128 0 589 940	black	Cowl, stainless steel , to avoid glare from 3 directions, for retro-fitting (one accessory per luminaire; not in combination)
128 0 589 960	white	
128 0 589 950	silver grey	

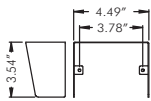

Part number	Colour	Description
128 0 588 940	black	Barn doors, aluminium , to avoid glare from 4 directions for retro-fitting (one accessory per luminaire; not in combination)
128 0 588 960	white	
128 0 588 950	silver grey	

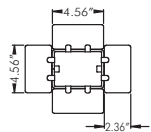

Part number	Colour	Description
129 0 390 940	black	Earth spike, stainless steel , for use in landscaped areas
129 0 390 960	white	
129 0 390 950	silver grey	

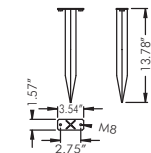

Part number	Colour	Description
125 0 160 940	black	Wall bracket 8.66" , aluminium, polyester powder coated, allows horizontal adjustment and directional aiming of luminaire
125 0 160 960	white	
125 0 160 950	silver grey	

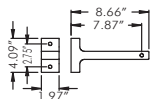

Part number	Colour	Description
128 0 651 940	black	Light Lock* , to lock inclination of floodlight into place
128 0 651 960	white	
128 0 651 950	silver grey	

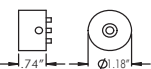

*Patent pending

When the light fitting has been pivoted, e.g. during re-lamping, Light Lock ensures that it can be returned to the original angle of orientation afterwards. The cap with tilt scale has to be removed from one side of the luminaire.



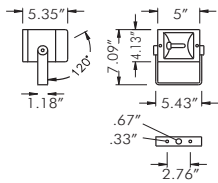

Gizmo Micro
Axially symmetrical wide beam

- . die cast aluminum body
- . 20W or Ceramic MH
- . CSA listed wet label
- . IP65 suitable for up or down aiming
- . integral 120v electronic ballast
- . tempered glass lens
- . polyester powder coat finish

Gizmo Micro axially symmetrical wide beam 20W

Part Number	Color	Lamp	Lampholder	Beam angle		Weight
				C 0-180	C 90-270	
TGW-9-AZ-B-78-0-0-T-00	Text. Black	20W Philips Ceramic MH 3000K CRI 85	GU 6.5	62°	31°	2.9 LBS
TGW-9-AZ-B-EW-0-0-T-00	Euro white	20W Philips Ceramic MH 3000K CRI 85	GU 6.5	62°	31°	2.9 LBS
TGW-9-AZ-B-10-0-0-T-002	Matte silver	20W Philips Ceramic MH 3000K CRI 85	GU 6.5	62°	31°	2.9 LBS

Note: Available in 120V only
 Note: Change the "B" to "Y" to convert from yoke mount to arm mount (See page 30)
 Note: Change the "0" to a "1" for short arm or "2" for a long arm (See page 30)

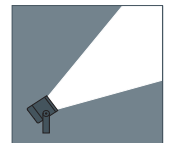
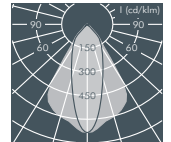
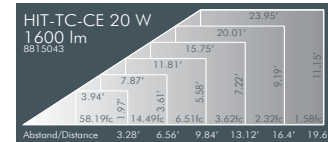

Internally fitted louvers are protected from dust and debris.



Gizmo Micro
Asymmetrical wide beam

- . die cast aluminum body
- . 20W Ceramic MH
- . CSA listed wet label
- . IP65 suitable for up or down aiming
- . integral 120v electronic ballast
- . tempered glass lens
- . polyester powder coat finish

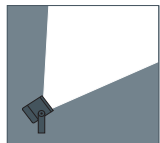
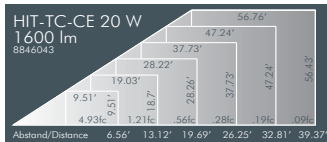
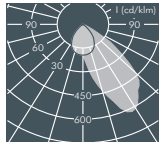
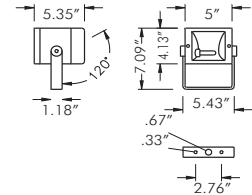

Gizmo Micro axially symmetrical wide beam 20W

Part Number	Color	Lamp	Lampholder	Beam angle		Weight
				C 0-180	C 90-270	
TGA-9-AZ-B-78-0-0-T-00	Text. Black	20W Philips Ceramic MH 3000K CRI 85	GU 6.5	74°	50°	2.9 LBS
TGA-9-AZ-B-EW-0-0-T-00	Euro white	20W Philips Ceramic MH 3000K CRI 85	GU 6.5	74°	50°	2.9 LBS
TGA-9-AZ-B-10-0-0-T-002	Matte silver	20W Philips Ceramic MH 3000K CRI 85	GU 6.5	74°	50°	2.9 LBS

Note: Available in 120V only
 Note: Change the "B" to "Y" to convert from yoke mount to arm mount (see page 30)
 Note: Change the "0" to "1" for short arm or "2" for long arm (see page 30)



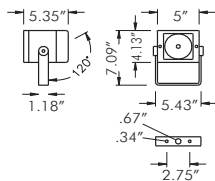

Gizmo Micro
Rotationally symmetrical,
narrow and medium wide beam

- . die cast aluminum body
- . 20W Ceramic MH
- . CSA listed wet label
- . IP65 suitable for up or down aiming
- . integral 120v electronic ballast
- . tempered glass lens
- . polyester powder coat finish

Gizmo Micro rotationally symmetrical narrow beam 20W Metal Halide

Part Number	Color	Lamp	Lampholder	Beam angle	Weight
TGN-9-AZ-B-78-0-0-T-00	Text. Black	20W Philips Ceramic MH 3000K CRI 85	GU 6.5	7°	2.9 LBS
TGN-9-AZ-B-EW-0-0-T-00	Euro white	20W Philips Ceramic MH 3000K CRI 85	GU 6.5	7°	2.9 LBS
TGN-9-AZ-B-10-0-0-T-002	Matte silver	20W Philips Ceramic MH 3000K CRI 85	GU 6.5	7°	2.9 LBS

Note: Available in 120V only
 Note: Change the "8" to "1" to convert from yoke mount to arm mount (see page 30)
 Note: Change the "0" to "1" for short arm or "2" for long arm (see page 30)

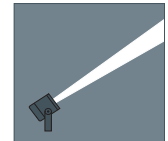
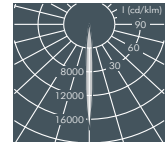
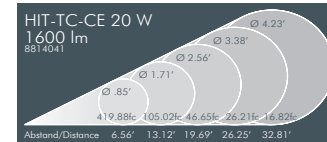

Gizmo Micro rotationally symmetrical beam with linear prism vertical spread 20W Metal Halide

Part Number	Color	Lamp	Lampholder	Beam angle	Weight
TGA-9-AZ-B-78-0-0-L-00	Text. Black	20W Philips Ceramic MH 3000K CRI 85	GU 6.5	34° 10°	2.9 LBS
TGA-9-AZ-B-EW-0-0-L-00	Euro white	20W Philips Ceramic MH 3000K CRI 85	GU 6.5	34° 10°	2.9 LBS
TGA-9-AZ-B-10-0-0-L-00	Matte silver	20W Philips Ceramic MH 3000K CRI 85	GU 6.5	34° 10°	2.9 LBS

Note: Available in 120V only
 Note: change the "L" to "R" for horizontal beam spread
 Note: Change the "8" to "1" to convert from yoke mount to arm mount (see page 30)
 Note: Change the "0" to "1" for short arm or "2" for long arm (see page 30)

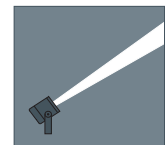
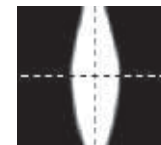
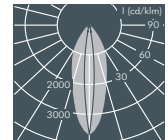
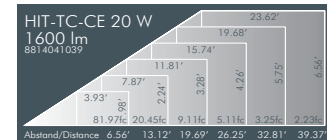

Gizmo Micro rotationally symmetrical medium wide beam 20W Metal Halide

Part Number	Color	Lamp	Lampholder	Beam angle	Weight
TGM-9-AZ-B-78-0-0-T-00	Text. Black	20W Philips Ceramic MH 3000K CRI 85	GU 6.5	28°	2.9 LBS
TGM-9-AZ-B-EW-0-0-T-00	Euro white	20W Philips Ceramic MH 3000K CRI 85	GU 6.5	28°	2.9 LBS
TGM-9-AZ-B-10-0-0-T-00	Matte silver	20W Philips Ceramic MH 3000K CRI 85	GU 6.5	28°	2.9 LBS

Note: Available in 120V only
 Note: Change the "8" to "1" to convert from yoke mount to arm mount (see page 30)
 Note: Change the "0" to "1" for short arm or "2" for long arm (see page 30)

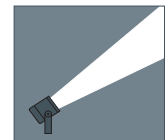
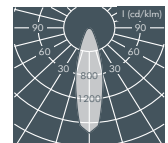
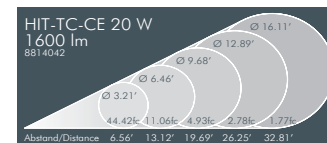

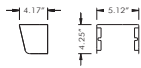

Gizmo Micro Accessories		
Part number	Colour	Description
128 0 524 940	black	Cowl* , stainless steel, to avoid glare from 3 directions
128 0 524 960	white	
128 0 524 950	silver grey	

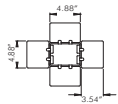

Part number	Colour	Description
128 0 562 940	black	Barn doors , aluminium, to avoid glare from 4 directions, variable control of light distribution, for mounting on front of floodlight
128 0 562 960	white	
128 0 562 950	silver grey	

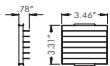
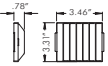

Part number	Description
128 0 614 000	Vertical louvre , stainless steel, internally fitted, to reduce lateral glare
128 0 615 000	Horizontal louvre , stainless steel, internally fitted, to reduce vertical glare

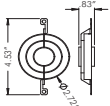

Part number	Description
128 0 619 000	Radial louvre , stainless steel, internally fitted, to reduce glare from all directions

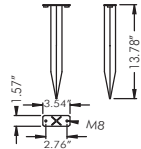

Part number	Colour	Description
129 0 390 940	black	Earth spike , stainless steel, for use in landscaped areas
129 0 390 960	white	
129 0 390 950	silver grey	

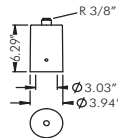

Part number	Colour	Description
128 0 625 940	black	Pole top fitter , aluminium, for pole 2.99", with R3/8" thread, for mounting one floodlight
128 0 625 960	white	
128 0 625 950	silver grey	

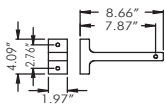

Part number	Colour	Description
125 0 160 940	black	Wall bracket 8.66" , aluminium, polyester powder coated, permits luminaire to be turned horizontally and aimed
125 0 160 960	white	
125 0 160 950	silver grey	

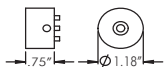

Part number	Colour	Description
128 0 630 940	black	Light Lock* , to lock inclination of floodlight into place
128 0 630 960	white	
128 0 630 950	silver grey	

*Patent pending

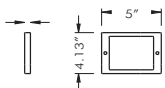

Gizmo Micro Accessories		
Part number	Colour	Description
128 0 551 940	black frame	Yellow colour filter* c/w aluminium frame
128 0 551 960	white frame	
128 0 551 950	silver grey frame	
128 0 557 940	black frame	Red colour filter* c/w aluminium frame
128 0 557 960	white frame	
128 0 557 950	silver grey frame	
128 0 553 940	black frame	Blue colour filter* c/w aluminium frame
128 0 553 960	white frame	
128 0 553 950	silver grey frame	
128 0 558 940	black frame	Green colour filter* c/w aluminium frame
128 0 558 960	white frame	
128 0 558 950	silver grey frame	

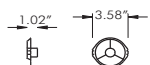

Accessories only for Gizmo Micro rotationally symmetrical narrow and medium wide beam	
Part number	Description
128 0 545 000	Glare control sleeve , to reduce scattered light

* For retro-fitting. Only one accessory per luminaire, not in combination.

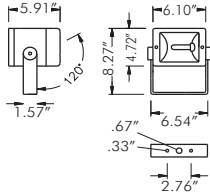
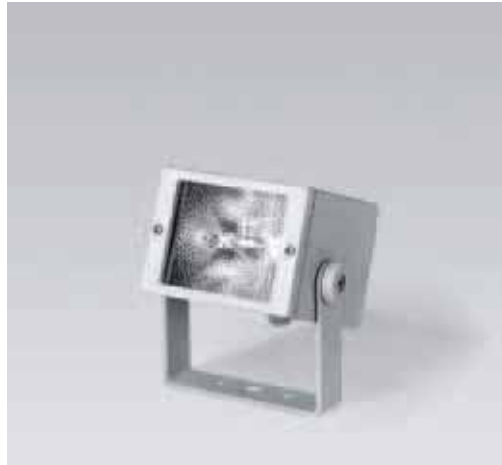

Gizmo Mini
Axially symmetrical wide beam

- . die cast aluminum body
- . 39w Ceramic MH
- . CSA listed wet label
- . IP65 suitable for up or down aiming
- . integral universal voltage electronic ballast
- . tempered glass lens
- . polyester powder coat finish

Gizmo Mini Axially symmetrical wide beam 39W Metal Halide

Part Number	Color	Lamp	Lampholder	Beam angle		Weight
				C 0-180	C 30-270	
MGW-9-2W-B-78-0-C-T-00	Text. Black	39W Philips T4 Ceramic MH 3000K CRI 81	G 8.5	68°	29°	6.2 LBS
MGW-9-2W-B-EW-0-C-T-00	Euro white	39W Philips T4 Ceramic MH 3000K CRI 81	G 8.5	68°	29°	6.2 LBS
MGW-9-2W-B-10-0-C-T-00	Matte silver	39W Philips T4 Ceramic MH 3000K CRI 81	G 8.5	68°	29°	6.2 LBS

Supplied with universal electronic universal voltage ballast
 Note: Change the "B" to "Y" to convert from yoke mount to arm mount (see page 30)
 Note: Change the "0" to "1" for short arm or "2" for long arm (see page 30)

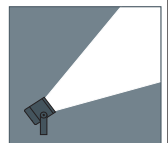
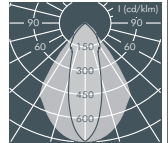
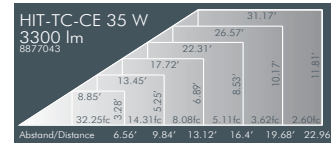

Internally fitted louvres are protected from dust and debris.



Gizmo Mini
Asymmetrical wide beam

- . die cast aluminum body
- . 39w Ceramic MH
- . CSA listed wet label
- . IP65 suitable for up or down aiming
- . integral universal voltage electronic ballast
- . tempered glass lens
- . polyester powder coat finish

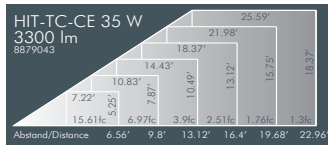
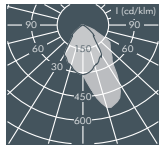
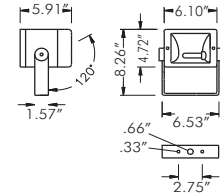

Gizmo Mini Asymmetrical wide beam 39W Metal Halide

Part Number	Color	Lamp	Lampholder	Beam angle		Weight
				C 0-100	C 90-270	
MGA-9-2W-B-78-0-C-T-00	Text. Black	39W Philips T4 Ceramic MH 3000K CRI 81	G 8.5	68°	43°	6.2 LBS
MGA-9-2W-B-EW-0-C-T-00	Euro white	39W Philips T4 Ceramic MH 3000K CRI 81	G 8.5	68°	43°	6.2 LBS
MGA-9-2W-B-10-0-C-T-00	Matte silver	39W Philips T4 Ceramic MH 3000K CRI 81	G 8.5	68°	43°	6.2 LBS

Supplied with universal electronic universal voltage ballast
 Note: Change the "B" to "Y" to convert from yoke mount to arm mount (see page 30)
 Note: Change the "0" to "1" for short arm or "2" for long arm (see page 30)

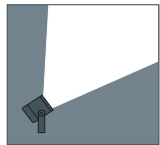

Internally fitted louvers are protected from dust and debris.



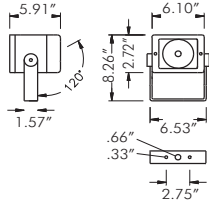

Gizmo Mini
Rotationally symmetrical
narrow beam/medium wide beam

- . die cast aluminum body
- . 39w Ceramic MH
- . CSA listed wet label
- . IP65 suitable for up or down aiming
- . integral universal voltage electronic ballast
- . tempered glass lens
- . polyester powder coat finish

Gizmo Mini rotationally symmetrical narrow beam 39W Metal Halide

Part Number	Color	Lamp	Lampholder	Beam angle	Weight
MGN-9-2W-B-78-0-C-T-00	Text. Black	39W Philips T4 Ceramic MH 3000K CRI 81	G 8.5	7°	6.2 LBS
MGN-9-2W-B-EW-0-C-T-00	Euro white	39W Philips T4 Ceramic MH 3000K CRI 81	G 8.5	7°	6.2 LBS
MGN-9-2W-B-10-0-C-T-00	Matte silver	39W Philips T4 Ceramic MH 3000K CRI 81	G 8.5	7°	6.2 LBS

Supplied with universal electronic universal voltage ballast
 Note: Change the "B" to "Y" to convert from yoke mount to arm mount (see page 30)
 Note: Change the "0" to "1" for short arm or "2" for long arm (see page 30)

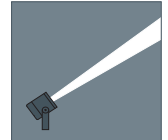
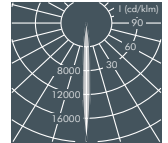
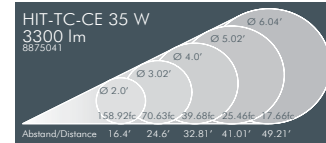

Gizmo Mini rotationally symmetrical narrow beam with linear prism vertical 39W Metal Halide

Part Number	Color	Lamp	Lampholder	Beam angle		Weight
				C 0-180	C 90-270	
MGN-9-2W-B-78-0-C-L-00	Text. Black	39W Philips T4 Ceramic MH 3000K CRI 81	G 8.5	34°	10°	6.2 LBS
MGN-9-2W-B-EW-0-C-L-00	Euro white	39W Philips T4 Ceramic MH 3000K CRI 81	G 8.5	34°	10°	6.2 LBS
MGN-9-2W-B-10-0-C-L-00	Matte silver	39W Philips T4 Ceramic MH 3000K CRI 81	G 8.5	34°	10°	6.2 LBS

Note: change the "L" to "R" for horizontal beam spread
 Note: Change the "B" to "Y" to convert from yoke mount to arm mount (see page 30)
 Note: Change the "0" to "1" for short arm or "2" for long arm (see page30)

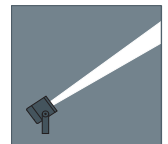
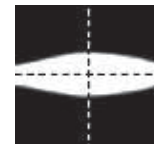
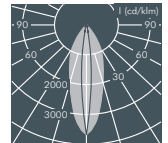
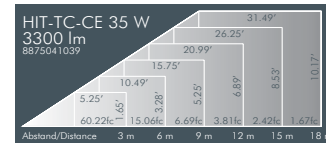

Gizmo Mini rotationally symmetrical medium wide beam 39W Metal Halide

Part Number	Color	Lamp	Lampholder	Beam angle	Weight
MGM-9-2W-B-78-0-C-T-00	Text. Black	39W Philips T4 Ceramic MH 3000K CRI 81	G 8.5	26°	6.2 LBS
MGM-9-2W-B-EW-0-C-T-00	Euro white	39W Philips T4 Ceramic MH 3000K CRI 81	G 8.5	26°	6.2 LBS
MGM-9-2W-B-10-0-C-T-00	Matte silver	39W Philips T4 Ceramic MH 3000K CRI 81	G 8.5	26°	6.2 LBS

Supplied with universal electronic universal voltage ballast
 Note: Change the "B" to "Y" to convert from yoke mount to arm mount (see page 30)
 Note: Change the "0" to "1" for short arm or "2" for long arm (see page 30)

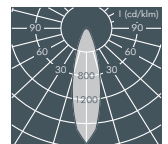
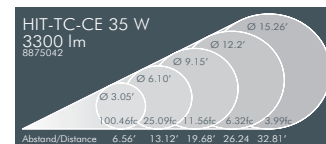

Accessories only for Gizmo Mini
rotationally symmetrical narrow and medium wide beam

Part number	Description
128 0 544 000	Glare control sleeve , to reduce scattered light

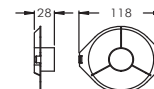

Accessories for Gizmo Mini

Part number	Colour	Description
128 0 484 940	black	Cowl* , stainless steel, to avoid glare from 3 directions, on front of floodlight
128 0 484 960	white	
128 0 484 950	silver grey	

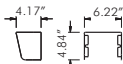

Part number	Colour	Description
128 0 480 940	black	Barn doors* , aluminium, to avoid glare from 4 directions, variable control of light distribution
128 0 480 960	white	
128 0 480 950	silver grey	

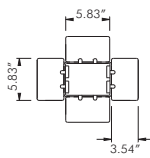

Part number	Description
128 0 620 000	Vertical louvre , stainless steel, internally fitted, to reduce lateral glare

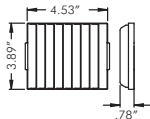

Part number	Description
128 0 621 000	Horizontal louvre , stainless steel, internally fitted, to reduce vertical glare

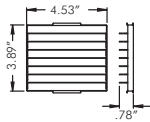

Part number	Description
128 0 619 000	Radial louvre , stainless steel, internally fitted, to reduce glare from all directions

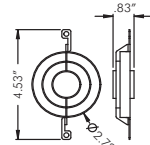

Part number	Colour	Description
129 0 390 940	black	Earth spike , stainless steel, for use in landscaped areas
129 0 390 960	white	
129 0 390 950	silver grey	

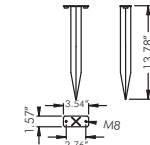

Part number	Colour	Description
128 0 625 940	black	Pole top fitter , aluminium, for pole 2.99", with R3/8" thread, for mounting one floodlight
128 0 625 960	white	
128 0 625 950	silver grey	

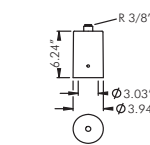

Part number	Colour	Description
128 0 631 940	black	Light Lock* , to lock inclination of floodlight into place
128 0 631 960	white	
128 0 631 950	silver grey	

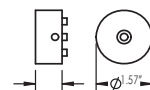

*Patent pending

Part number	Colour	Description
128 0 047 940	black	Wall arm 39.37" , aluminium, polyester powder coated, for illumination of signs and facades, cable duct inside, max. load 17.64 lbs
128 0 047 960	white	
128 0 047 950	silver grey	

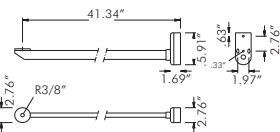

Part number	Colour	Description
128 0 491 940	black frame	Yellow colour filter* c/w aluminium frame
128 0 491 960	white frame	
128 0 491 950	silver grey frame	
128 0 497 940	black frame	Red colour filter* c/w aluminium frame
128 0 497 960	white frame	
128 0 497 950	silver grey frame	
128 0 493 940	black frame	Blue colour filter* c/w aluminium frame
128 0 493 960	white frame	
128 0 493 950	silver grey frame	
128 0 498 940	black frame	Green colour filter* c/w aluminium frame
128 0 498 960	white frame	
128 0 498 950	silver grey frame	



* For retro-fitting. Only one accessory per luminaire, not in combination.

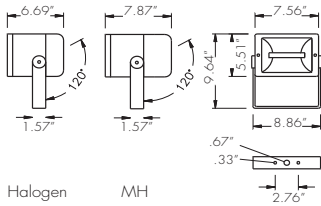

Gizmo

Axially symmetrical wide beam

- . die cast aluminum body
- . 70w D/E Ceramic MH or 300w D/E Halogen
- . CSA listed wet label
- . IP65 suitable for up or down aiming
- . integral universal voltage electronic ballast for MH version
- . tempered glass lens
- . polyester powder coat finish

Gizmo Axially symmetrical wide beam 70W Metal Halide

Part Number	Color	Lamp	Lampholder	Beam angle		Weight
				C 0-180	C 30-270	
GIW-9-L5-B-78-0-C-T-00	Text. Black	70W Philips TD 6 D/E Ceramic MH 3000K CRI 82	Rx7s	71°	27°	8.4 LBS
GIW-9-L5-B-EW-0-C-T-00	Euro white	70W Philips TD 6 D/E Ceramic MH 3000K CRI 82	Rx7s	71°	27°	8.4 LBS
GIW-9-L5-B-10-0-C-T-00	Matte silver	70W Philips TD 6 D/E Ceramic MH 3000K CRI 82	Rx7s	71°	27°	8.4 LBS

Note: Change the "B" to "Y" to convert from yoke mount to arm mount (see page 30)
 Note: Change the "0" to "1" for short arm or "2" for long arm (see page 30)

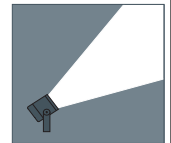
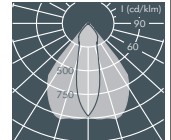
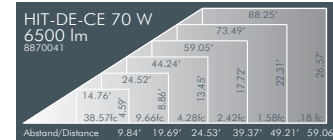

Gizmo Axially symmetrical wide beam 300W Halogen

Part Number	Color	Lamp	Lampholder	Beam angle		Weight
				C 0-180	C 30-270	
GIW-7-C1-B-78-0-F-T-00	Text. Black	300W T3 Double ended Halogen	RSC	73°	26°	5.75 LBS
GIW-7-C1-B-EW-0-F-T-00	Euro white	300W T3 Double ended Halogen	RSC	73°	26°	5.75 LBS
GIW-7-C1-B-10-0-F-T-00	Matte silver	300W T3 Double ended Halogen	RSC	73°	26°	5.75 LBS

Note: Change the "B" to "Y" to convert from yoke mount to arm mount (see page 30)
 Note: Change the "0" to "1" for short arm or "2" for long arm (see page 30)

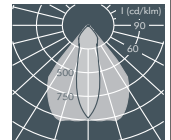
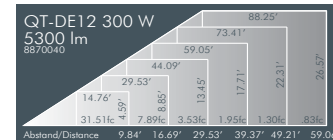

Gizmo Micro
Asymmetrical wide beam

- . die cast aluminum body
- . 70w D/E Ceramic MH or 300w D/E Halogen
- . CSA listed wet label
- . IP65 suitable for up or down aiming
- . integral universal voltage electronic ballast for MH version
- . tempered glass lens
- . polyester powder coat finish

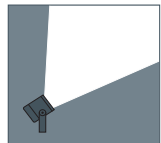
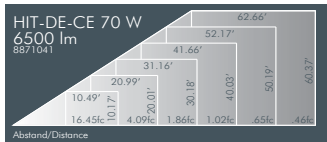
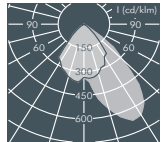
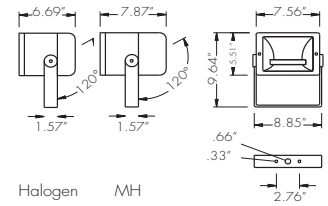

Gizmo Asymmetrical wide beam 70W Metal Halide

Part Number	Color	Lamp	Lampholder	Beam angle		Weight
				C 0-180	C 90-270	
GIA-9-L5-B-78-0-C-T-00	Text. Black	70W Philips TD 6 D/E Ceramic MH 3000K CRI 82	Rx7s	74°	44°	8.4 LBS
GIA-9-L5-B-EW-0-C-T-00	Euro white	70W Philips TD 6 D/E Ceramic MH 3000K CRI 82	Rx7s	74°	44°	8.4 LBS
GIA-9-L5-B-10-0-C-T-00	Matte silver	70W Philips TD 6 D/E Ceramic MH 3000K CRI 82	Rx7s	74°	44°	8.4 LBS

Note: Change the "B" to "Y" to convert from yoke mount to arm mount (see page 30)
 Note: Change the "0" to "1" for short arm or "2" for long arm (see page 30)

Gizmo Asymmetrical wide beam 300W Halogen

Part Number	Color	Lamp	Lampholder	Beam angle		Weight
				C 0-180	C 90-270	
GIA-7-C1-B-78-0-F-T-00	Text. Black	300W T3 Double ended Halogen	RSC	74°	44°	5.75 LBS
GIA-7-C1-B-EW-0-F-T-00	Euro white	300W T3 Double ended Halogen	RSC	74°	44°	5.75 LBS
GIA-7-C1-B-10-0-F-T-00	Matte silver	300W T3 Double ended Halogen	RSC	74°	44°	5.75 LBS

Note: Change the "B" to "Y" to convert from yoke mount to arm mount (see page 30)
 Note: Change the "0" to "1" for short arm or "2" for long arm (see page 30)



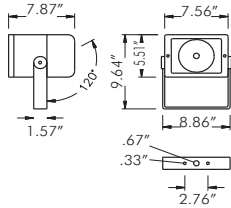

Gizmo
Rotationally symmetrical narrow beam

- . die cast aluminum body
- . 70W Ceramic MH
- . CSA listed wet label
- . IP65 suitable for up or down aiming
- . integral universal voltage electronic ballast
- . tempered glass lens
- . polyester powder coat finish

Gizmo Rotationally symmetrical narrow beam 70W Metal Halide

Part Number	Color	Lamp	Lampholder	Beam angle	Weight
GIA-9-L5-B-78-0-C-T-00	Text. Black	70W Philips TD6 Ceramic MH 3000K CRI 81	G12	7°	8.4 LBS
GIA-9-L5-B-EW-0-C-T-00	Euro white	70W Philips TD6 Ceramic MH 3000K CRI 81	G12	7°	8.4 LBS
GIA-9-L5-B-10-0-C-T-00	Matte silver	70W Philips TD6 Ceramic MH 3000K CRI 81	G12	7°	8.4 LBS

Supplied with universal electronic universal voltage ballast
 Note: Change the "B" to "Y" to convert from yoke mount to arm mount (see page 30)
 Note: Change the "0" to "1" for short arm or "2" for long arm (see page 30)

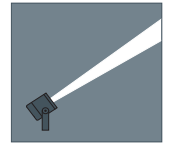
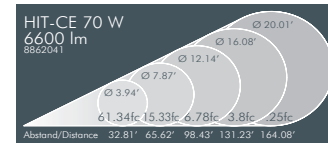

Gizmo Rotationally symmetrical narrow beam 70W Metal Halide

Part Number	Color	Lamp	Lampholder	Beam angle	Weight
GIA-9-9X-B-78-0-C-T-00	Text. Black	100W Philips TD6 Ceramic MH 3000K CRI 81	G12	7°	8.4 LBS
GIA-9-9X-B-EW-0-C-T-00	Euro white	100W Philips TD6 Ceramic MH 3000K CRI 81	G12	7°	8.4 LBS
GIA-9-9X-B-10-0-C-T-00	Matte silver	100W Philips TD6 Ceramic MH 3000K CRI 81	G12	7°	8.4 LBS

Supplied with universal electronic universal voltage ballast
 Note: Change the "B" to "Y" to convert from yoke mount to arm mount (see page 30)
 Note: Change the "0" to "1" for short arm or "2" for long arm (see page 30)

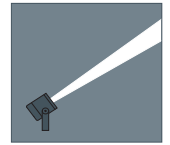
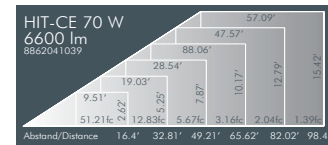

Gizmo rotationally symmetrical narrow beam with linear prism vertical 70W Metal Halide

Part Number	Color	Lamp	Lampholder	Beam angle		Weight
				C 0-180	C 90-270	
GIN-9-L5-B-78-0-C-L-00	Text. Black	70W Philips TD6 Ceramic MH 3000K CRI 81	G12	9°	33°	8.4 LBS
GIN-9-L5-B-EW-0-C-L-00	Euro white	70W Philips TD6 Ceramic MH 3000K CRI 81	G12	9°	33°	8.4 LBS
GIN-9-L5-B-10-0-C-L-00	Matte silver	70W Philips TD6 Ceramic MH 3000K CRI 81	G12	9°	33°	8.4 LBS

Note: change the "L" to "R" for horizontal beam spread
 Note: Change the "B" to "Y" to convert from yoke mount to arm mount (see page 30)
 Note: Change the "0" to "1" for short arm or "2" for long arm (see page 30)



Gizmo
Rotationally symmetrical
medium wide beam

- . die cast aluminum body
- . 70w or 100w Ceramic MH
- . CSA listed wet label
- . IP65 suitable for up or down aiming
- . integral universal voltage electronic ballast
- . tempered glass lens
- . polyester powder coat finish

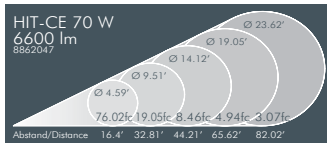
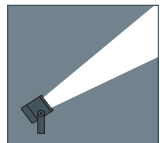
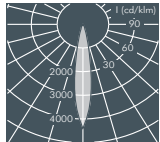
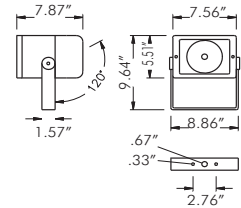

Gizmo Rotationally symmetrical medium wide beam 70W Metal Halide

Part Number	Color	Lamp	Lampholder	Beam angle	Weight
GMW-9-L5-B-78-0-C-T-00	Text. Black	70W Philips TD6 Ceramic MH 3000K CRI 81	G12	16°	8.4 LBS
GMW-9-L5-B-EW-0-C-T-00	Euro white	70W Philips TD6 Ceramic MH 3000K CRI 81	G12	16°	8.4 LBS
GMW-9-L5-B-10-0-C-T-00	Matte silver	70W Philips TD6 Ceramic MH 3000K CRI 81	G12	16°	8.4 LBS

Supplied with universal electronic universal voltage ballast
 Note: Change the "B" to "Y" to convert from yoke mount to arm mount (see page 30)
 Note: Change the "0" to "1" for short arm or "2" for long arm (see page 30)

Gizmo Rotationally symmetrical medium wide beam 70W Metal Halide

Part Number	Color	Lamp	Lampholder	Beam angle	Weight
GMW-9-9X-B-78-0-C-T-00	Text. Black	100W Philips TD6 Ceramic MH 3000K CRI 81	G12	16°	8.4 LBS
GMW-9-9X-B-EW-0-C-T-00	Euro white	100W Philips TD6 Ceramic MH 3000K CRI 81	G12	16°	8.4 LBS
GMW-9-9X-B-10-0-C-T-00	Matte silver	100W Philips TD6 Ceramic MH 3000K CRI 81	G12	16°	8.4 LBS

Supplied with universal electronic universal voltage ballast
 Note: Change the "B" to "Y" to convert from yoke mount to arm mount (see page 30)
 Note: Change the "0" to "1" for short arm or "2" for long arm (see page 30)



Accessories for Gizmo

Part number	Colour	Description
128 O 235 000	unpainted	Ceiling recess frame , stainless steel, outer dimensions 10.63" x 12.59", in kit form, ready for assembly, adjustable height of fitting, min. recess depth 5.91"
128 O 235 940	black	
128 O 235 960	white	
128 O 235 950	silver grey	

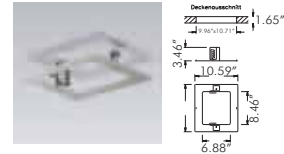

Part number	Colour	Description
128 O 035 940	black	Barn doors* , aluminium, to avoid glare from 4 directions, variable control of light distribution, for mounting on front of floodlight
128 O 035 960	white	
128 O 035 950	silver grey	

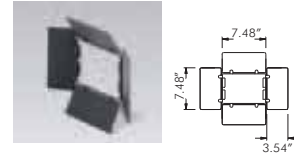

Part number	Colour	Description
128 O 031 940	black	Cowl* , stainless steel, to avoid glare from 3 directions, for mounting on front of floodlight
128 O 031 960	white	
128 O 031 950	silver grey	



Part number	Colour	Description
128 O 352 940	black	Protection grill* , stainless steel, c/w aluminium frame, to protect the glass from stone chip and vandalism, for mounting on front of floodlight
128 O 352 960	white	
128 O 352 950	silver grey	

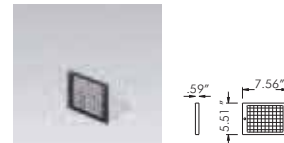

*For retrofitting. Only one accessory per luminaire, not in combination

Part number	Colour	Description
129 O 390 940	black	Earth spike , stainless steel, for use in landscaped areas
129 O 390 960	white	
129 O 390 950	silver grey	

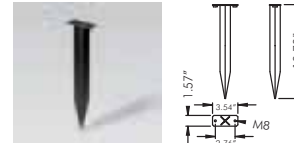

Part number	Colour	Description
120 O 240 940	black	Universal pole clamp , aluminium, polyester powder coated, stainless steel bolts, for mounting on poles 1.57"-4.33"
120 O 240 960	white	
120 O 240 950	silver grey	



Part number	Colour	Description
125 O 197 940	black	Corner fixing bracket A , aluminium, polyester powder coated, for mounting floodlights on 90° corners
125 O 197 960	white	
125 O 197 950	silver grey	



Part number	Colour	Description
128 O 246 940	black	Connection box , aluminium, IP55, polyester powder coated, with thread R3/8", for mounting one floodlight, PG11 cable gland, 2 rubber cable grommets for through wiring, surface mounted or recessed cable
128 O 246 960	white	
128 O 246 950	silver grey	



Part number	Colour	Description
125 O 160 940	black	Wall bracket 8.66" , aluminium, polyester powder coated, allows horizontal adjustment and directional aiming of luminaire
125 O 160 960	white	
125 O 160 950	silver grey	

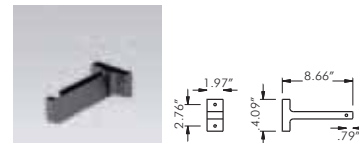

Part number	Colour	Description
128 O 294 940	black	Wall bracket 17.72" , aluminium, polyester powder coated, allows horizontal adjustment and directional aiming of luminaire
128 O 294 960	white	
128 O 294 950	silver grey	

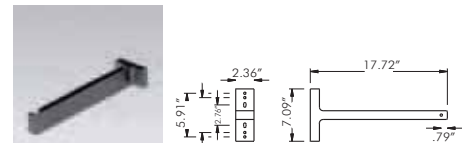

Part number	Colour	Description
128 O 047 940	black	Wall arm 39.37" , aluminium, polyester powder coated, for illumination of signs and facades, cable duct inside, max. load 17.64 lbs
128 O 047 960	white	
128 O 047 950	silver grey	

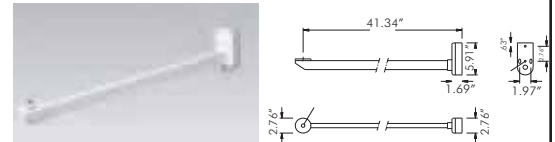

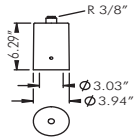

Accessories for Gizmo

Part number	Colour	Description
128 0 625 940	black	Pole top fitter , aluminium, for pole 2.99", with R3/8" thread, for mounting one floodlight
128 0 625 960	white	
128 0 625 950	silver grey	

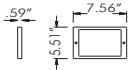

Part number	Colour	Description
128 0 403 940	black frame	Yellow colour filter* c/w aluminium frame (not suitable for use on 8 868 ... fittings)
128 0 403 960	white frame	
128 0 403 950	silver grey frame	

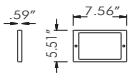

Part number	Colour	Description
128 0 393 940	black frame	Red colour filter* c/w aluminium frame (not suitable for use on 8 868 ... fittings)
128 0 393 960	white frame	
128 0 393 950	silver grey frame	

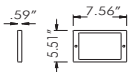

Part number	Colour	Description
128 0 383 940	black frame	Blue colour filter* c/w aluminium frame (not suitable for use on 8 868 ... fittings)
128 0 383 960	white frame	
128 0 383 950	silver grey frame	

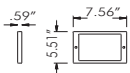

Part number	Colour	Description
128 0 418 940	black frame	Green colour filter* c/w aluminium frame (not suitable for use on 8 868 ... fittings)
128 0 418 960	white frame	
128 0 418 950	silver grey frame	

* For retro-fitting. Only one accessory per luminaire, not in combination.

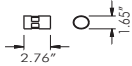

Accessories for Gizmo rotationally symmetrical narrow beam and medium wide beam only

Part number	Description
128 0 370 000	Glare control sleeve , to reduce scattered light

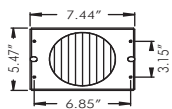

Accessories for Gizmo, rotationally symmetrical narrow beam

Part number	Colour	Description
128 0 622 940	black	Rotatable ribbed glass spreader lens , for linear beam distribution, continuously adjustable through 360°, with stainless steel frame
128 0 622 960	white	
128 0 622 950	silver grey	

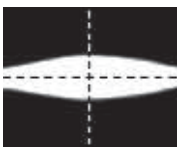

Accessories for Gizmo 70/100 W

Part number	Colour	Description
128 0 631 940	black	Light Lock* , to lock inclination of floodlight into place
128 0 631 960	white	
128 0 631 950	silver grey	

*Patent pending

When the light fitting has been pivoted, e.g. during re-lamping, Light Lock ensures that it can be returned to the original angle of orientation afterwards. The cap with tilt scale has to be removed from one side of the luminaire.

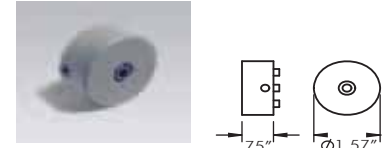

Accessories for Gizmo 100 W

Part number	Description
128 0 565 000	Vertical louvre* , stainless steel, internally fitted, to reduce lateral glare

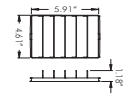

Part number	Description
128 0 566 000	Horizontal louvre* , stainless steel, internally fitted, to reduce vertical glare

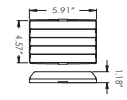

Part number	Description
128 0 585 000	Radial louvre* , stainless steel, internally fitted, to reduce glare from all directions

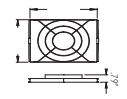

Accessories for Superlight Compact 150 W

Part number	Colour	Description
128 0 033 940	black	Horizontal louvre* , stainless steel, to reduce lateral glare, for mounting on front of floodlight
128 0 033 960	white	
128 0 033 950	silver grey	

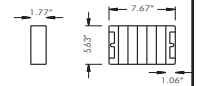

Part number	Colour	Description
128 0 368 940	black	Horizontal louvre* , stainless steel, to reduce lateral glare, for mounting on front of floodlight
128 0 368 960	white	
128 0 368 950	silver grey	

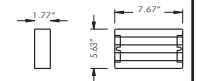

Part number	Colour	Description
128 0 431 940	black	Radial louvre* , stainless steel, to reduce lateral glare, for mounting on front of floodlight
128 0 431 960	white	
128 0 431 950	silver grey	

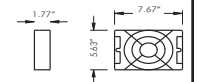

* For retro-fitting. Only one accessory per luminaire, not in combination.

Gizmo Micro, Gizmo Mini, Gizmo with telescopic wall arm and joint

- . die cast aluminum body
- . CSA listed wet label
- . IP65 suitable for up or down aiming
- . integral electronic ballast
- . tempered glass lens
- . polyester powder coat finish

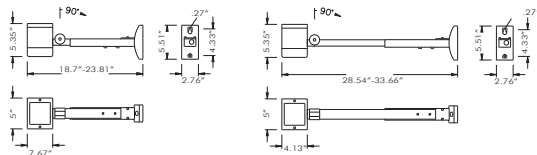

Gizmo Micro 20 W

Part number	Description	Length
TGW ...B.. 0	TGW ...Y.. 1 Gizmo micro with short arm	18.70" - 23.82"
TGW ...B.. 0	TGW ...Y.. 2 Gizmo micro with long arm	28.54" - 33.66"

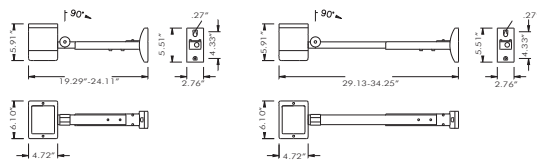

Gizmo Mini 39 W

Part number	Description	Length
MGW ...B.. 0	MGW ...Y.. 1 Gizmo mini with short arm	19.29" - 24.41"
MGW ...B.. 0	MGW ...Y.. 2 Gizmo mini with long arm	29.13" - 34.25"

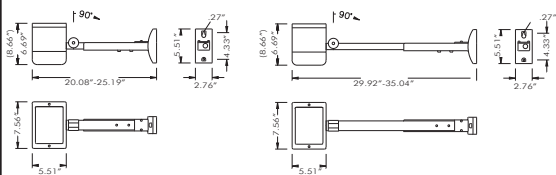

Gizmo 70, 100 W

Part number	Description	Length
GIW ...B.. 0	GIW ...Y.. 1 Gizmo with short arm	20.08" - 25.19"
GIW ...B.. 0	GIW ...Y.. 2 Gizmo with long arm	29.92" - 35.04"



All luminaires of the series

Gizmo Micro, Gizmo Mini, and Gizmo

can be ordered c/w telescopic wall arm by using the above part number variation.

designplan 

designplan  MEYER LIGHTING

79 Trenton Avenue • Frenchtown, NJ 08825 • Tel: (908) 996-7710 • Fax: (908) 996-7042
www.designplan.com

The products shown in this catalog are designed and engineered by **Willy Meyer + Sohn**. They are assembled under license by Designplan Lighting, Inc.