

Branch Sconce

Sconces

50 Greene St
New York NY 10013
T +1 212 388 1621
sales@rbw.com

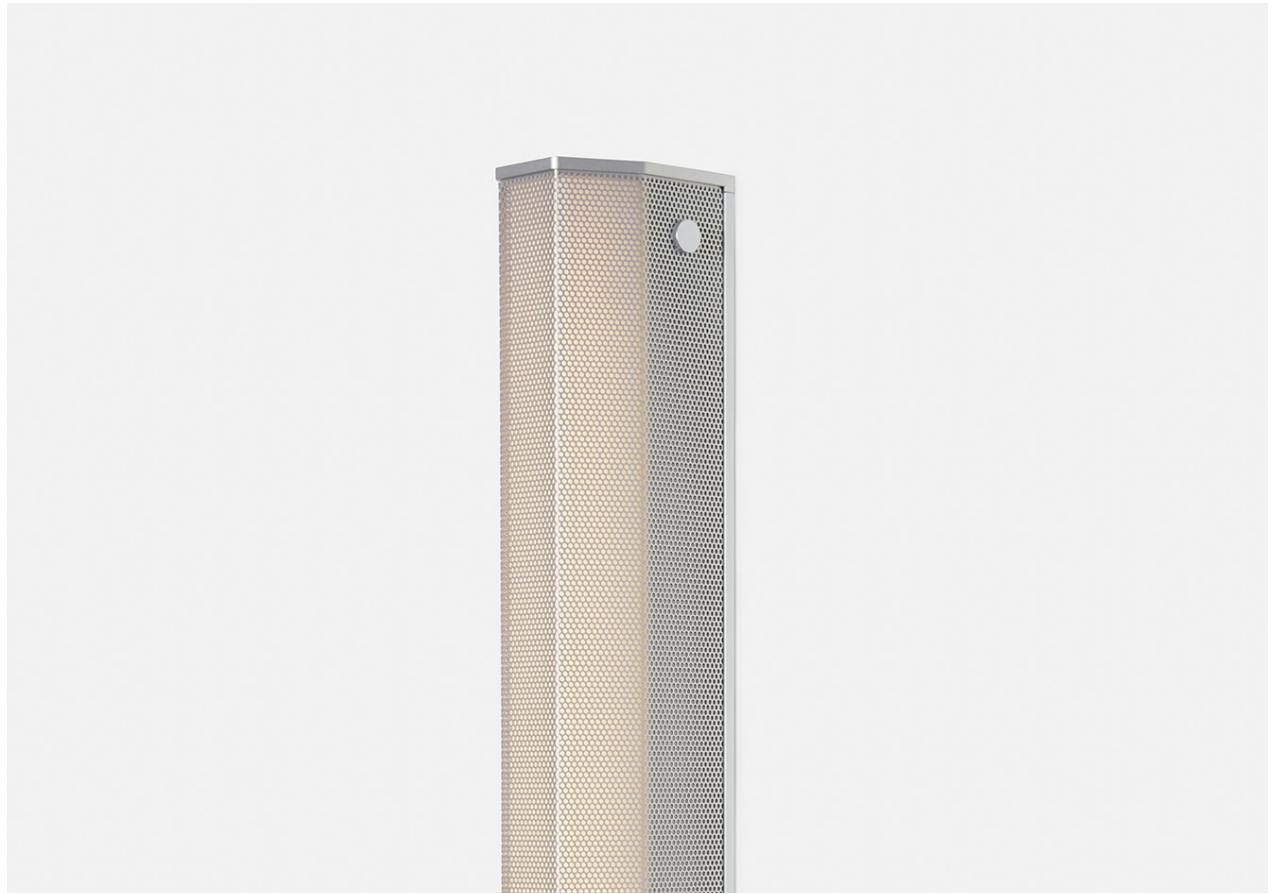



For 2D & 3D drawings of all products, including CAD, Revit and IES files, please visit rbw.com

DESCRIPTION

Perforated metal shells sit comfortably atop diffuser lenses, in this family of lights. This fixture is available in a variety of warm anodized finishes and warm color temperatures, adding atmosphere to any space.

MATERIALS

Perforated anodized aluminum, acrylic lens

PERFORMANCE

Small 200 lm | Medium 435 lm | Large 870 lm

Power Consumption for Small 9W | Medium 18W | Large 37W

Luminaire Watts for Small 9W | Medium 18W | Large 37W

Small 20 lm/W | Medium 23 lm/W | Large 23 lm/W

90 CRI

LED LIFESPAN

50k hours

CERTIFICATION

ADA Compliant

UL Listed

Suitable for Damp Locations

IP44



PRODUCT DIMENSIONS

Small 3 x 3 x 13 in H | Medium 3 x 3 x 24 in H | Large 3 x 3 x 46 in H

PRODUCT WEIGHT

8 lbs / 3.6 kg

DIMENSIONAL WEIGHT

Small 4 lbs | Medium 9 lbs | Large 16 lbs

YOUR PRODUCT CODE

BRES-M-AA01-22-277_10_DIN

Specification Logic

SIZE

Large 46"

L

Medium 24"

M

Small 12.5"

S

Generate Date: Mon Dec 27 2021

SHADE FINISH

Natural Anodize	AA01
Gold Anodize	AA03
Black Anodize	AA04
Copper Anodize	AA06

COLOR TEMPERATURE

2200K (candle light)	22
2700K (warm white)	27
3000K (soft white)	30
3500K (neutral white)	35
4000K (cool white)	40

INPUT / CONTROL / POWER

110-277V Input 0-10V, 0.1% dimming	277_10_DIN
110-277V Input DALI, 0.1% dimming	277_DL_DIN
110-277V Input TRIAC 1% dimming	277_TR_DIN

Drawings

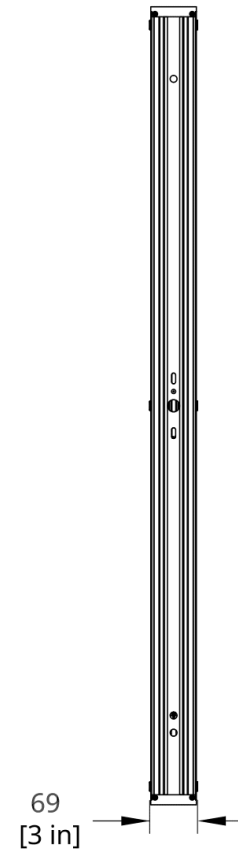
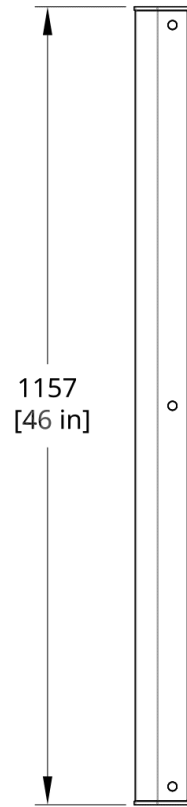
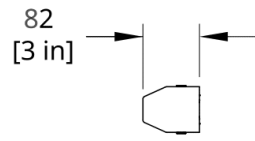

BRES-L Branch Sconce Large Dimension

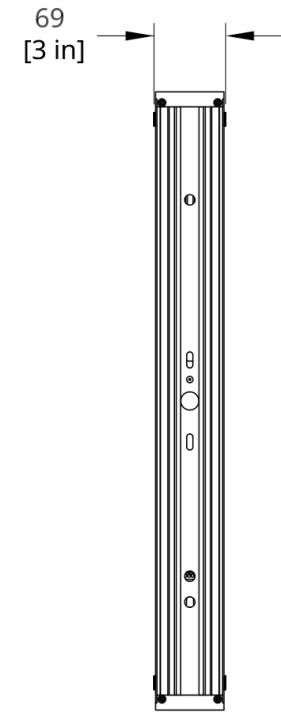
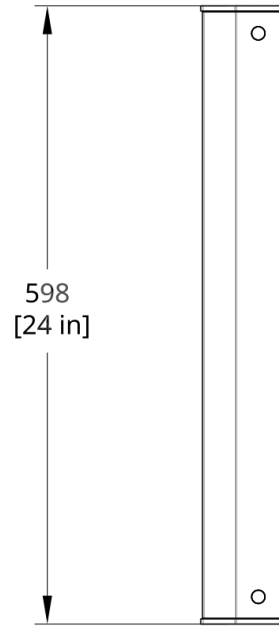
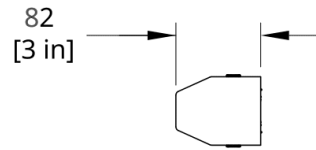

BRES-M Branch Sconce Medium Dimension

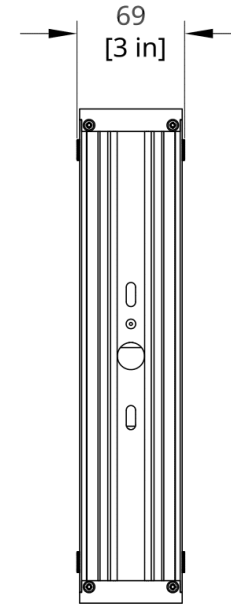
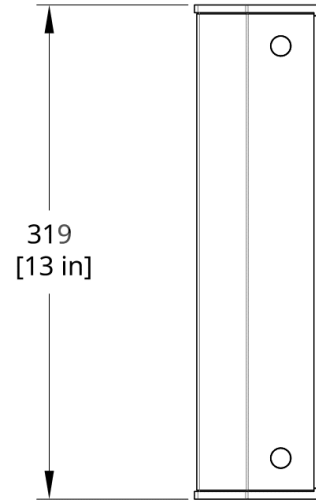
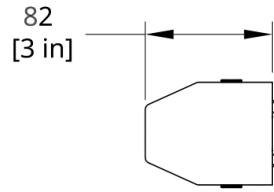

BRES-S Branch Sconce Small Dimension