

# Radiant Sconce



Sconces

50 Greene St  
New York NY 10013  
T +1 212 388 1621  
sales@rbw.com



For 2D & 3D drawings of all products, including CAD, Revit and IES files, please visit [rbw.com](http://rbw.com)

Generate Date: Thu Jan 06 2022

**DESCRIPTION**

With no visible fasteners or light sources to be found, the Radiant wall sconces' simple presentation belies sophisticated construction. Light emanates from behind solid-wood fixtures that seem to be floating, giving Radiant a warm, however mysterious, effect.

**MATERIALS**

Solid wood, acrylic lens, metallic powder coat aluminum base

**PERFORMANCE**

400 lm

Power Consumption 11W

Luminaire Watts 11W

36.4 lm/W

90 CRI

**LED LIFESPAN**

50k hours

**CERTIFICATION**

UL Listed

Suitable for Damp Locations

**PRODUCT DIMENSIONS**

12 dia x 4 ln depth

**PRODUCT WEIGHT**

4.5 lbs / 2 kg

**DIMENSIONAL WEIGHT**

3 lbs

---

YOUR PRODUCT CODE

RA- [ ] - [ ] - [ ] - [ ] - [ ]

---

Specification Logic

**WOOD FINISH**

---

|              |      |
|--------------|------|
| White Oak    | WF01 |
| Ebonized Oak | WF02 |
| Walnut       | WF03 |
| White        | WF04 |

**COLOR TEMPERATURE**

---

|                       |    |
|-----------------------|----|
| 2700K (warm white)    | 27 |
| 3000K (soft white)    | 30 |
| 3500K (neutral white) | 35 |

**INPUT / CONTROL / POWER**

---

|  |             |
|--|-------------|
| 110-120V Input TRIAC, ELV, 0-10V 1% Dimming      | 120_TM_DIN  |
| 220-240V Input 0-10V, 1% Dimming                 | 220_10_DIN  |
| 220-240V Input ELV / Reverse Phase, 1% Dimming   | 220_ELV_DIN |
| 220-240V Input TRIAC / Forward Phase, 1% Dimming | 220_TR_DIN  |

Drawings

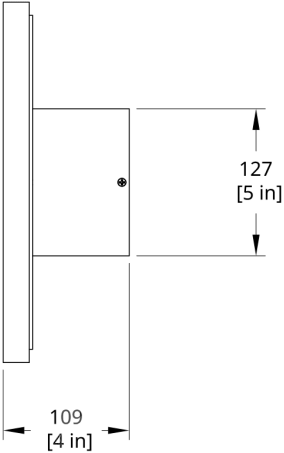
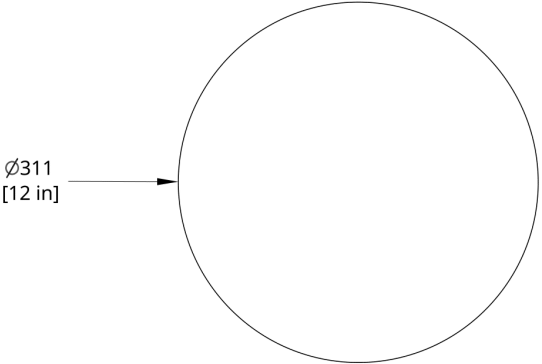

RA Radiant Sconce Dimension